

IAN U

\_\_\_\_\_ I n .

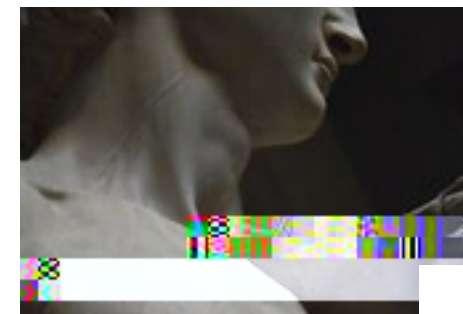
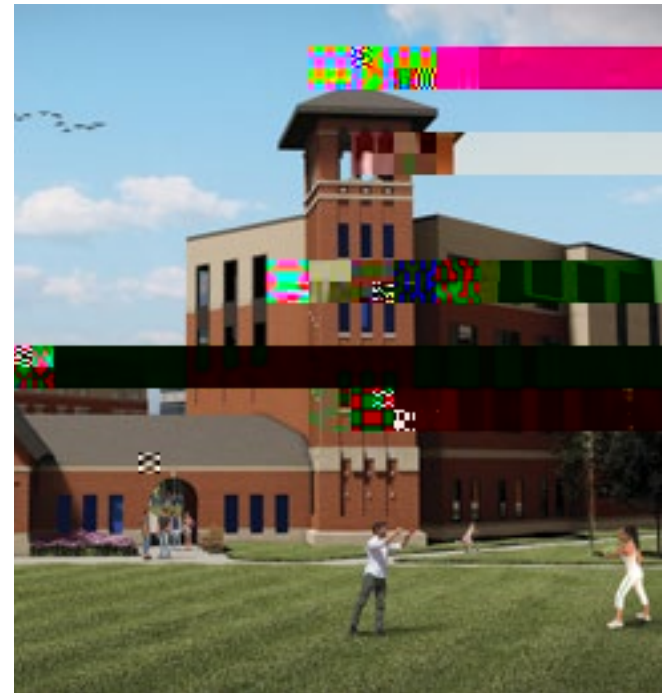
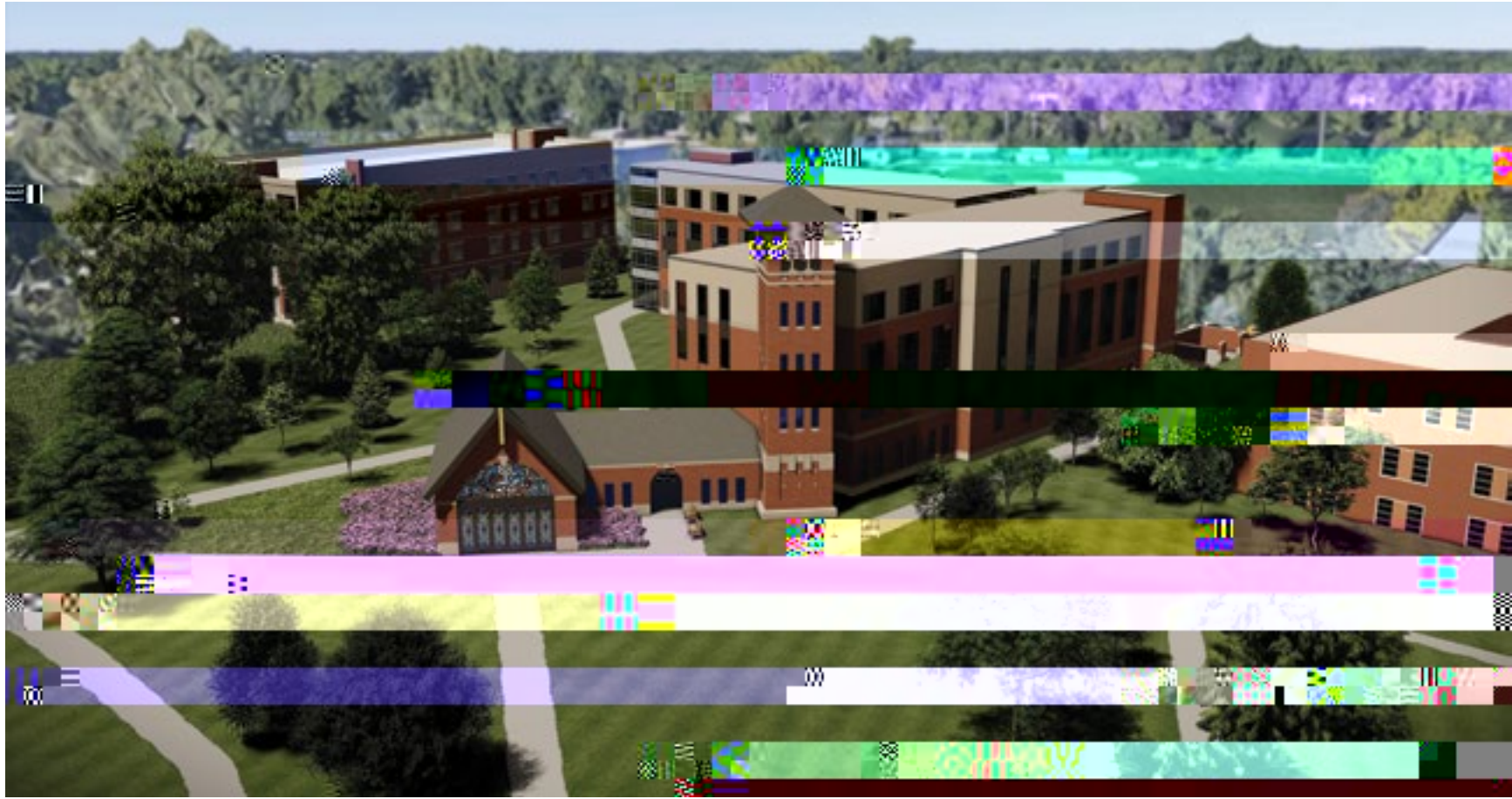

**Becky Kuhlman Hiatt '16:** I have been a member of the Phi Kappa Phi Honor Society since my freshman year. I was honored to be elected to the Phi Kappa Phi Honor Society in my senior year. I am proud to be a member of this organization and to have been elected to the Phi Kappa Phi Honor Society. I am proud to be a member of this organization and to have been elected to the Phi Kappa Phi Honor Society.

**Madison McKinney '16:** I have been a member of the Phi Kappa Phi Honor Society since my freshman year. I was honored to be elected to the Phi Kappa Phi Honor Society in my senior year. I am proud to be a member of this organization and to have been elected to the Phi Kappa Phi Honor Society.

**Sierra Siebenlist '10:** I have been a member of the Phi Kappa Phi Honor Society since my freshman year. I was honored to be elected to the Phi Kappa Phi Honor Society in my senior year. I am proud to be a member of this organization and to have been elected to the Phi Kappa Phi Honor Society.

**Robert Geile '05:** I have been a member of the Phi Kappa Phi Honor Society since my freshman year. I was honored to be elected to the Phi Kappa Phi Honor Society in my senior year. I am proud to be a member of this organization and to have been elected to the Phi Kappa Phi Honor Society.

**Theresa Beam Roberts '15:** I have been a member of the Phi Kappa Phi Honor Society since my freshman year. I was honored to be elected to the Phi Kappa Phi Honor Society in my senior year. I am proud to be a member of this organization and to have been elected to the Phi Kappa Phi Honor Society.

**Bill Sanford '13:** I have been a member of the Phi Kappa Phi Honor Society since my freshman year. I was honored to be elected to the Phi Kappa Phi Honor Society in my senior year. I am proud to be a member of this organization and to have been elected to the Phi Kappa Phi Honor Society.

**Lauren McClaskey '20:** I have been a member of the Phi Kappa Phi Honor Society since my freshman year. I was honored to be elected to the Phi Kappa Phi Honor Society in my senior year. I am proud to be a member of this organization and to have been elected to the Phi Kappa Phi Honor Society.

**Kayla Bledsoe '20:** I have been a member of the Phi Kappa Phi Honor Society since my freshman year. I was honored to be elected to the Phi Kappa Phi Honor Society in my senior year. I am proud to be a member of this organization and to have been elected to the Phi Kappa Phi Honor Society.

**Hadley Hawkins '22:** I have been a member of the Phi Kappa Phi Honor Society since my freshman year. I was honored to be elected to the Phi Kappa Phi Honor Society in my senior year. I am proud to be a member of this organization and to have been elected to the Phi Kappa Phi Honor Society.





1.  $\frac{d}{dx} \ln(x^2 + 1) = \frac{2x}{x^2 + 1}$   
 2.  $\frac{d}{dx} \ln(x^2 - 1) = \frac{2x}{x^2 - 1}$   
 3.  $\frac{d}{dx} \ln(x^2 + 2x + 1) = \frac{2x + 2}{x^2 + 2x + 1}$   
 4.  $\frac{d}{dx} \ln(x^2 - 2x + 1) = \frac{2x - 2}{x^2 - 2x + 1}$

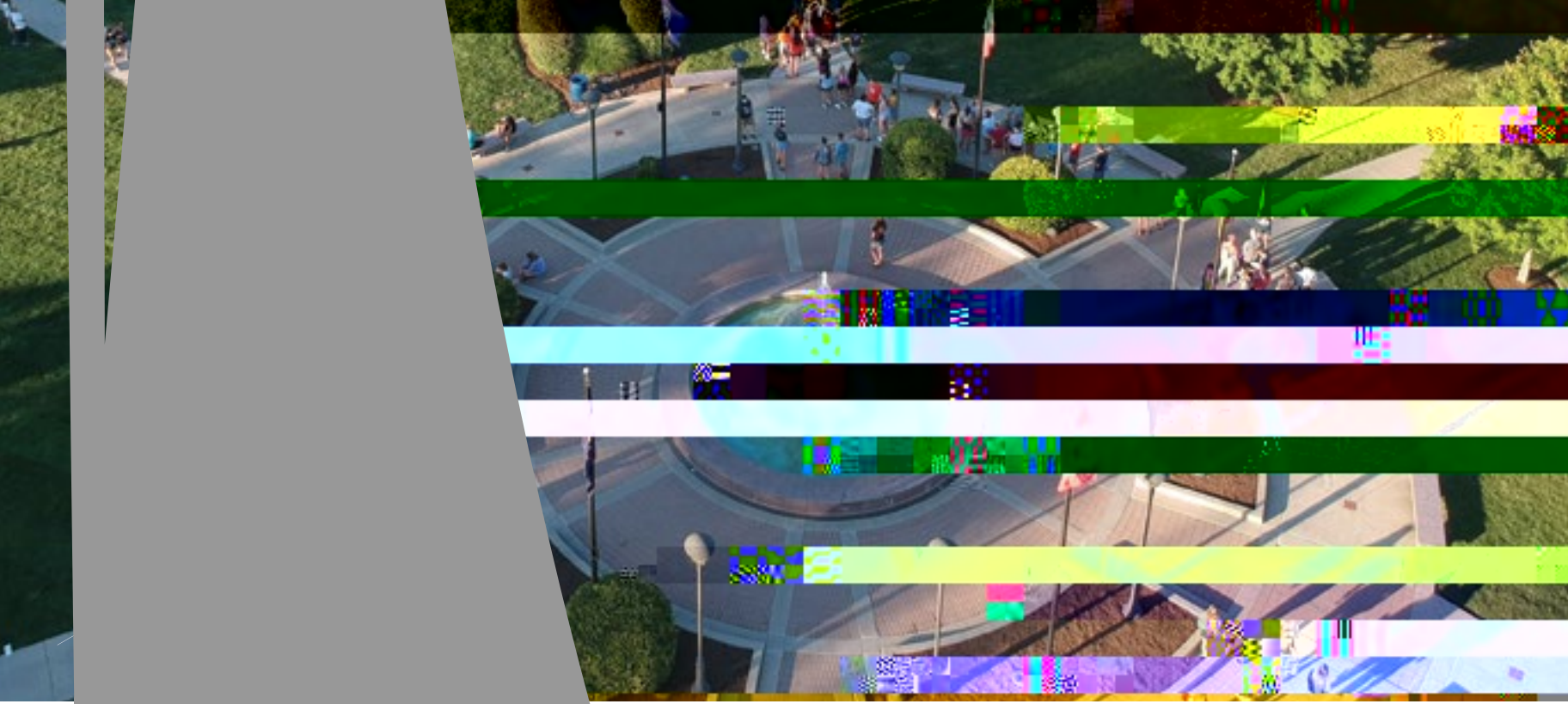

# How a Marian University Doctor Found a Medical Mystery in Michelangelo's 'David'

*The Indianapolis Star* 

While art historians have studied Michelangelo's "David" for centuries, it





In recent years, Marian University has embarked on several initiatives to help close the opportunity gap that exists in our society. Community leaders agree that Marian is helping





## FOUR KNIGHTS TEAMS COMPETE FOR NATIONAL TITLES

...the program's success is a direct result of the hard work and dedication of the players and coaches. The team's success is a testament to the program's commitment to excellence and the support of the university and its fans.

“ Our team worked so hard in the gym, weightroom, and classroom, and it was a direct correlation to what we were able to accomplish on the national stage. Winning a national championship does not happen in just one year. ”

— Ashlee Pritchard,  
Head Volleyball Coach

...the program's success is a direct result of the hard work and dedication of the players and coaches. The team's success is a testament to the program's commitment to excellence and the support of the university and its fans.

...the program's success is a direct result of the hard work and dedication of the players and coaches. The team's success is a testament to the program's commitment to excellence and the support of the university and its fans.

...the program's success is a direct result of the hard work and dedication of the players and coaches. The team's success is a testament to the program's commitment to excellence and the support of the university and its fans.

...the program's success is a direct result of the hard work and dedication of the players and coaches. The team's success is a testament to the program's commitment to excellence and the support of the university and its fans.

...the program's success is a direct result of the hard work and dedication of the players and coaches. The team's success is a testament to the program's commitment to excellence and the support of the university and its fans.



Women's Volleyball celebrates after winning the 2019 NAIA Women's Volleyball National Championship in Sioux City, Iowa, for the first time in program history.

...the program's success is a direct result of the hard work and dedication of the players and coaches. The team's success is a testament to the program's commitment to excellence and the support of the university and its fans.

...the program's success is a direct result of the hard work and dedication of the players and coaches. The team's success is a testament to the program's commitment to excellence and the support of the university and its fans.

...the program's success is a direct result of the hard work and dedication of the players and coaches. The team's success is a testament to the program's commitment to excellence and the support of the university and its fans.

...the program's success is a direct result of the hard work and dedication of the players and coaches. The team's success is a testament to the program's commitment to excellence and the support of the university and its fans.

...the program's success is a direct result of the hard work and dedication of the players and coaches. The team's success is a testament to the program's commitment to excellence and the support of the university and its fans.

...the program's success is a direct result of the hard work and dedication of the players and coaches. The team's success is a testament to the program's commitment to excellence and the support of the university and its fans.

...the program's success is a direct result of the hard work and dedication of the players and coaches. The team's success is a testament to the program's commitment to excellence and the support of the university and its fans.

...the program's success is a direct result of the hard work and dedication of the players and coaches. The team's success is a testament to the program's commitment to excellence and the support of the university and its fans.

...the program's success is a direct result of the hard work and dedication of the players and coaches. The team's success is a testament to the program's commitment to excellence and the support of the university and its fans.

...the program's success is a direct result of the hard work and dedication of the players and coaches. The team's success is a testament to the program's commitment to excellence and the support of the university and its fans.



Cyclists compete for the first place finish at the 2019 Collegiate Track National Championship.



1. [Link to the document](#)

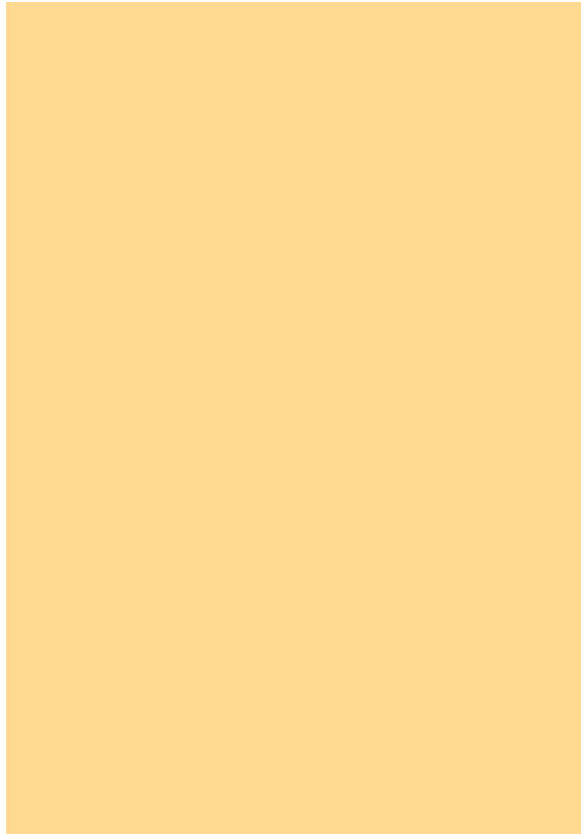
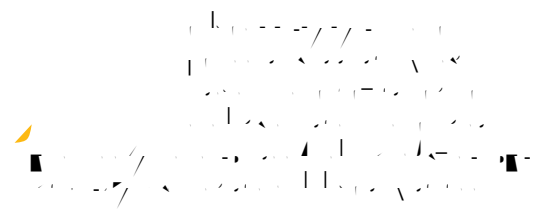



---

2014

Jordan Ahmayl

Charles Ayres

Michael

Barton

---

Mary Rose Turner Buechele '43  
Agnes Lang Amrine '44  
Mary Louise To olo Valchar '44  
Ruth Bill Jennewein '47  
Eleanor "Nora" Thompson Cardis '47  
Rosemary Doyle Becher '48  
Dorothy Bersch '48  
Suzanne Orth Roll '49  
Lois Mendenhall Bergho '50  
Margaret Yirga Hatke '50  
Sr. Helen Eckrich, OSF '51  
Beatrice Durham Jenkins '51  
Billie Eilers Skerrett '51  
Barbara Brunson Hawkins '52  
Sr. Virginia Ann Streit, OSF '52  
Edda Fiorino Camardo '53  
Francis Joan Clements, OSF '54  
Sr. Ruth Breig, OSF '58  
Nancy Reiber Hall '58  
Sr. Mary Ann Miles, OSF '58  
Judith Miller Thompson '58  
Sr. Rita Vukovic, OSF '58  
Patrick Henn '59  
Gerald Obergfell '59  
Elizabeth "Betty" Burnett Boenne '60  
Sr. Francis Ann Lewis, OSF '60

Vera Ramstetter Nash '60  
Sr. Norma Rocklage, OSF, Ph.D., '60  
Sr. Justin Louise Stiker, OSF '60  
Normalie Richards Strickland '60  
Robert Harmening '61  
Kathleen O'Connor Greene '62  
Judy Hardin Hall '62  
Tom Tarpey '62  
Marilyn Wiwi Bardon '64  
Joseph Keers '64  
Martha Wechsler Corrie '65  
Anna Marie Kiefer '67  
Dennis Pyritz '69  
Anne Marty Haire '72  
Donald Sartino '72  
Sr. Sharon Marie Blank, OSF '74  
Sharon Orr Fisko '77  
Susan Close Kern '79  
Frances Joan Long '79  
Mark Daniel '80  
Anna Enders Myers '85  
Barbara Mauch '88  
James Faulstich '93  
John Keesling '06  
Charles Frazee





## E. S. Witchger School of Engineering

The E. S. Witchger School of Engineering is a leading center for research and innovation in engineering and technology. Our faculty and students are dedicated to advancing the frontiers of knowledge and creating a better future for all.

To learn more, visit [marian.edu/wsoe](http://marian.edu/wsoe).

